



Western Illinois
University

WE BELIEVE IN WHERE YOUR POTENTIAL WILL TAKE YOU.

YOUR POTENTIAL. OUR PURPOSE.



2

CAMPUSES
MACOMB &
QUAD CITIES

13:1

STUDENT TO
FACULTY RATIO

18

AVERAGE
CLASS SIZE

7,600+

TOTAL
ENROLLMENT

\$17,646

AVERAGE FINANCIAL
AID AWARD



Welcome

Western Illinois University provides a place for success for anyone who dreams of getting an education. At Western, we believe that every student matters and we are committed to helping them grow. Through the lived experiences of our faculty and staff, we are able to connect and create unique learning opportunities for our students, enabling them to map their own future.

Amtrak

[amtrak.com](https://www.amtrak.com)

Twice-daily round-trip service to and from Chicago's Union Station, Macomb and Quincy, IL.

Bring Your Car

All students can bring a car to campus. A parking permit is \$60/year.

Go West

[wiu.edu/gowest](https://www.wiu.edu/gowest)

Free bus transportation around campus and Macomb



\$10M

SCHOLARSHIPS
AWARDED ANNUALLY

250+

STUDENT
ORGANIZATIONS

20+

CLUB SPORTS
TEAMS

17

NCAA
DIVISION 1
SPORTS TEAMS

0%

ANNUAL COST
INCREASE
COST GUARANTEE
[wiu.edu/costguarantee](https://www.wiu.edu/costguarantee)

Areas of Study

wiu.edu/academics

wiu.edu/catalog

A__

Accountancy
Actuarial Science
Adapted Recreation & Inclusion
Advertising & Public Relations
Agricultural Business
Agricultural Science
Agriculture*
American Government
Anthropology
Art*
Art Studio

B__

Biochemistry
Biology*
Botany
Broadcast Production
Broadcasting & Journalism
Business
Business Analytics

C__

Chemistry*
Civil Engineering
Clinical Laboratory Science
Communication
Communication Studies
Community Organizations
Computer Science
Construction & Facilities Management
Cyber Security

D__

Data Science & Statistics

E__

Economics
Education (Degrees/Options)
Agriculture Education (6-12)
Art Education (K-12)
Bilingual/ESL Education (K-12)
Biology Education (9-12)

E continued __

Chemistry Education (9-12)
Early Childhood Education (Birth-2)
Elementary Education (1-6)
English Education (9-12)
French Education (K-12)
History Education (9-12)
Mathematics Education (9-12)
Middle Level Education (5-8)
Music Education (K-12)
Physical Education (K-12)
Physics Education (9-12)
Spanish Education (K-12)
Special Education (K-12)
Educational Studies
Electrical Engineering
Emergency Management
Engineering
Engineering Physics
Engineering Technology
English*
Enterprise Marketing
Environmental Biology
Environmental Geology
Exercise Science

F__

Finance
Fire Administration
Fire Protection Services
Fire Science
Foreign Languages & Cultures
Forensic Chemistry
Forensic Psychology
French*

G__

General Studies
Geoenvironment & Planning
Geographic Information Science
Geology
Geospatial Science
Graphic Design

H__

Health Services Management
History*
Human Resource Management

I__

Information Systems
International Relations/Comparative Politics
Interpersonal Communication & Processes

L__

Law Enforcement & Justice Administration
Liberal Arts and Sciences

M__

Management
Marketing
Marketing Technology
Mathematics*
Mechanical Engineering
Medical Sciences
Meteorology
Microbiology
Multimedia Journalism
Music*
Music Business
Music Therapy
Musical Theatre

N__

Nursing - Pre Licensure
Nursing - RN/BSN Completion
Nutrition & Dietetics
Nutrition & Foodservice Management

O__

Omni-Channel Marketing
Organizational Communication
Outdoor Recreation

P__

Paleontology
Pharmacy
Physics*
Political Science
Pre-Engineering
Pre-Forestry
Pre-Health (Pre-Medicine)
Pre-Law (History)
Pre-Law (Political Science)
Pre-Veterinary Medicine
Psychology
Public Administration/Public Policy
Public Health

R__

Recreation, Park & Tourism Administration

S__

Social Influence
Social Work
Sociology
Spanish*
Speech Pathology & Audiology
Sports Broadcasting
Supply Chain Management

T__

Theatre (Performance)
Theatre (Production/Design)
Tourism, Hospitality & Event Management

Z__

Zoology



CUSTOMIZED, STATE-OF-THE-ART ACADEMIC FACILITIES

GROUNDBREAKING PROGRAMS & AWARD-WINNING PROFESSORS

WIU offers the following minors that do not have a matching major. Minors that have a matching major are not listed here but are available at wiu.edu/catalog.

Minors

African American Studies	International Studies
Aging Studies	Jazz Studies
Agricultural Economics	Law and Society
Agricultural Technology	Legal Studies
Management	Manufacturing Technology
Agronomy	Mental Health
Algorithms & Data Management	Military Science
American Sign Language	Natural Resources Conservation
Animal Science	Network Technologies
App Development	Neuroscience
Art History	Nonprofit Administration
Business	Occupational Safety
Cannabis & Culture	Operations Management
Cannabis Production	Outdoor Leadership
Coaching	Philosophy
Computer-Mediated	Plant Breeding
Communication	Pre-Law Honors
Computer Science Education	Pre-MBA
Construction & Facilities	Precision Agriculture
Technology	Professional Writing
Corrections	Public Administration and
Creative Writing	Public Service
Criminalistics	Queer Studies
Dance	Religious Studies
Environmental Studies	Scuba Diving
Event Planning and Management	Security Administration
Film	Sports Health & Wellness
Forensic Science	Stage Combat
Global Politics	Teaching English to Speakers of
Homeland Security	Other Languages (TESOL)
Horticulture	Therapeutic Recreation
Hospitality Management	Weather and Climate
Industrial Technology	Women's Studies
Information Technology	Youth Leadership
International Business	

Quad Cities Programs

Accountancy
Bilingual/ESL Education (K-12)
Civil Engineering
Communication
Community Organizations
Electrical Engineering
Elementary Education (1-6)
Engineering
Engineering Technology
English
Enterprise Marketing
General Studies
Human Resource Management
Information Systems
Law Enforcement & Justice
 Administration
Liberal Arts and Sciences
Management
Marketing
Marketing Technology
Mechanical Engineering
Psychology
Recreation, Park & Tourism
 Administration
Supply Chain Management

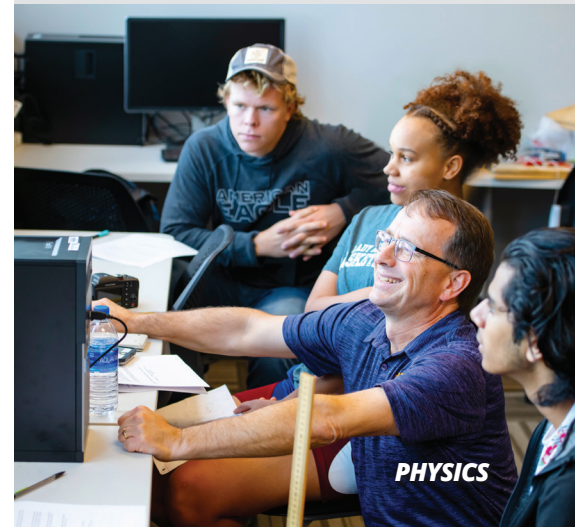

Integrated 5-Year Master's Degree Listing

Complete your bachelor's and master's degrees in 5 years.

Accountancy
Applied Statistics & Decision
Analytics
Business Administration (MBA)
Chemistry
Communication
Computer Science
Educational Studies
GIScience and Geoenvironment
History
Instructional Design &
Technology
Liberal Arts & Sciences
Mathematics
Museum Studies
Physics
Political Science
Public Safety Administration
Quantitative Economics
Recreation, Park & Tourism
Administration
Sociology
Sport Management

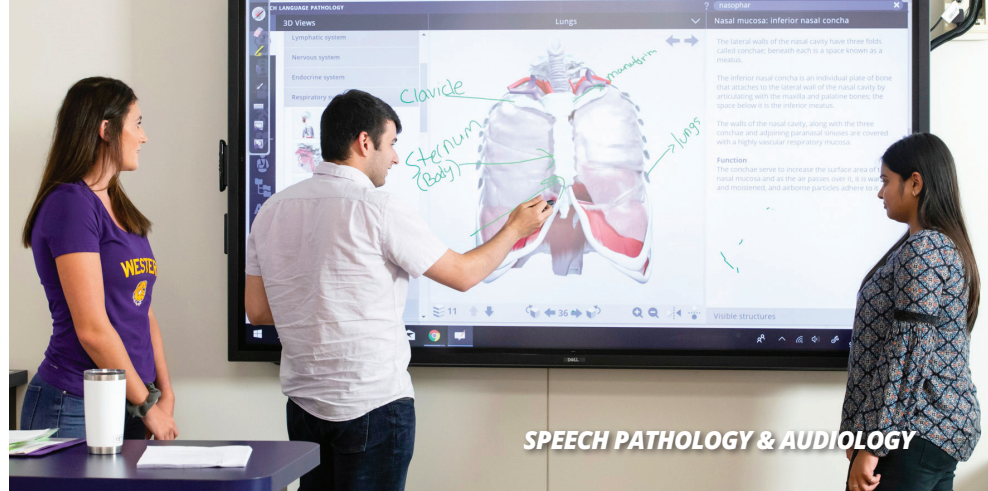

SPEECH PATHOLOGY & AUDIOLOGY



AGRICULTURE

Centennial Honors College

wiu.edu/honors

Honors students have the ability to

- complete unique courses
- participate in research
- gain leadership experience
- participate in service learning projects
- access exclusive scholarships

Honors College Entrance Requirements

New Freshmen

Must meet two of the three criteria

- 3.4+ GPA
- SAT 1160+/ACT 24+
- Top 15% of graduating class

New Transfers & Current Students

Must meet both criteria; honors credit may transfer

- 3.4+ GPA
- 12+ semester hours

Housing & Dining

wiu.edu/housing

Take advantage of a once-in-a-lifetime opportunity and live on campus. Choose from double or single room styles—see examples to the right and on our Housing website. Choose your roommate through Roommate Matching. Events and activities help you meet lifelong friends.

Living Learning Communities

Living Learning Communities allow you to live on a floor with students who share an area of interest:

Agriculture

Broadcasting & Journalism

Business Studies

Centennial Honors

CLASS (Community of Liberal
Arts & Sciences)

Fine Arts

ROTC

STEM

Transfer Year Experience

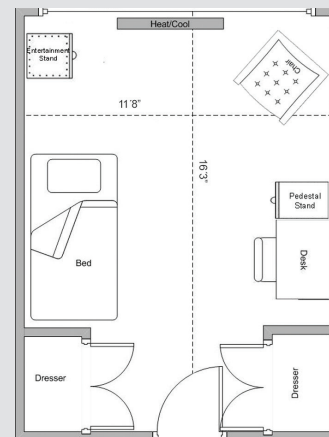

Lincoln-Washington
single/super

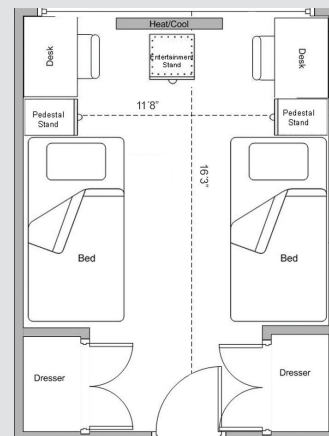

Lincoln-Washington
double

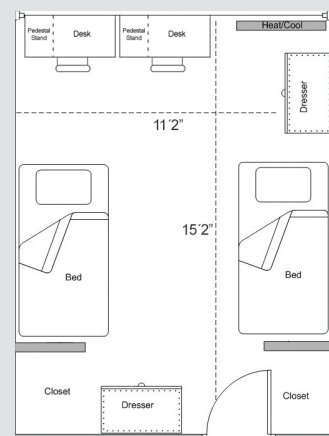

Thompson
double

THOMPSON HALL



LIVE LIFE ON CAMPUS

THOMPSON HALL ROOM



THOMPSON HALL DINING





Multicultural Centers

Casa Latina Cultural Center

wiu.edu/casa

Explore ethnic identity development, social justice, community outreach, cultural expression and professional networking. Choose from six student organizations and participate in Latinx Heritage Month, Dia de los Muertos, Calle Murray and more.

LGBT*QA Resource Center

wiu.edu/lgbtqa

Connect with resources, support and programs for Lesbian, Gay, Bisexual, Trans*, Queer/ Questioning, Asexual/Ally (LGBT*QA) students. Participate in organizations like Unity and activities like The Big Picture Picnic, Camp OUT, Trans* Day of Remembrance, Pride Month and more.

Gwendolyn Brooks Cultural Center

wiu.edu/gbcc

Promotes student success through Black cultural awareness, academic achievement and social advocacy. Choose from eight student organizations and participate in Taste of Africa, Black History Month, Feel Good Fridays and more.

Women's Center

wiu.edu/wc

Empowers and celebrates women, and welcomes students of all genders. Join five organizations and show your support at events like Love Your Body Day, Take Back the Night and more.

250+ STUDENT ORGANIZATIONS

wiu.edu/studentlife



Get Involved

- Academic
- Greek
- Multicultural
- Fine Arts
- Leadership
- Volunteer/Service

Interfraternity Council (IFC)

Alpha Gamma Rho
Alpha Gamma Sigma
Alpha Gamma Phi
Delta Tau Delta
Delta Upsilon
Pi Kappa Phi
Sigma Alpha Epsilon
Sigma Chi
Sigma Pi
Tau Kappa Epsilon
Theta Chi
Theta Xi

Panhellenic Council (PHC)

Alpha Sigma Alpha
Alpha Sigma Tau
Chi Omega

United Greek Council (UGC)

Alpha Kappa Alpha
Alpha Phi Alpha
Alpha Psi Lambda
Gamma Phi Omega
Lambda Theta Alpha
Lambda Theta Phi
Omega Psi Phi
Sigma Gamma Rho
Sigma Lambda Gamma
Zeta Phi Beta

Delta Zeta
Phi Sigma Sigma
Sigma Sigma Sigma





TRADITION OF TOUGH

Division I Athletics



goleathernecks.com

With 62 conference championships and nine NCAA Division I football playoff appearances in the books, WIU Athletics offers students seven venues to support their Fighting Leathernecks, where you get in free with just a student ID.

Baseball

Basketball (M/W)

Cross Country (M/W)

Football

Golf (M/W)

Soccer (M/W)

Softball

Tennis (W)

Track & Field (M/W)

Volleyball

Sports Clubs

Badminton Club	Men's Soccer
Baseball Club	Mixed Martial Arts Club
Bowling Club	Outdoorsman's Club
E-sports (Western Electronic Gaming Association)	Paintball
Equestrian Club	Running Club
Equestrian Show Team	Tennis Club
Live Action Role Playing Network	Ultimate Frisbee
Men's Club Volleyball	Water Polo
Men's Lacrosse	Women's Rugby Football Club
Men's Rugby Football Club	Women's Volleyball Club
	Wrestling Club

12
INTRAMURALS

20
SPORT CLUBS

\$1,000
CLUB SPORTS SCHOLARSHIP

FREE
FITNESS CENTER
CLASSES, CLUBS & AQUATICS



SAT Test Code: **1900**

ACT Test Code: **1158**



Become a Leatherneck

Apply

Apply online at wiu.edu/apply.
Admission is test optional—SAT/ACT scores are not required.

- ☐ **2.75+ GPA on a 4.0 scale**
You will be admitted.
- ☐ **2.0-2.74 GPA on a 4.0 scale**
Your application will be reviewed and additional information may be requested.

950-1150
SAT

FALL 2019
MIDDLE 50%

2.7-3.5
GPA

FALL 2019
MIDDLE 50%

18-25
ACT

FALL 2019
MIDDLE 50%

Transfer

wiu.edu/transfer

Considering community college? Transfer to WIU or participate in WIU's Transfer Admissions Guarantee (TAG). Earn guaranteed admission to WIU with 24+ credits and a 2.0+ cumulative GPA. Automatic scholarships are also available.

Disability Resource Center

wiu.edu/sdsc

As part of the Student Development and Success Center, the Disability Resource Center assists students with accommodations for note-taking, alternate delivery formats and more.

Western Commitment Scholarships

Awards are determined by GPA and, if available, test scores. Calculate your award at wiu.edu/westerncommitment.

3.9+ GPA **\$8,000** *annually*

3.6+ GPA **\$6,000** *annually*

3.3+ GPA **\$3,000** *annually*

Scholarship Deadlines

Visit wiu.edu/scholarships for scholarship applications and additional degree-based opportunities.



President's Scholarships
December 1



Freshmen Foundation Scholarships
March 1

Macomb Tuition & Fees

Annual Cost to Attend: **\$21,524***

Average Financial Aid & Scholarships: **\$17,646**

Use the cost calculator to determine your cost at wiu.edu/costs.

*Annual estimates are for a new student enrolling in 15 credit hours for the fall and spring semesters at the Macomb campus with a residence hall double room and basic meal plan. Estimates do not include textbooks, student health insurance or personal expenses.

Cost Guarantee

wiu.edu/costguarantee

WIU is the only Illinois public university to lock in your tuition, fee, room and meal plan rates for four years.

No Out-Of-State Tuition

WIU offers in-state tuition rates to all U.S. students.



Financial Aid

wiu.edu/fa | WIU Code: 001780

FAFSA opens October 1. If eligible, file early to ensure maximum consideration.



**Scan to request
additional info
about WIU!**



wiu.edu/request

Visit

Schedule a visit at
wiu.edu/visit.

Experience
WIU's caring and
supportive learning
environment first-
hand.

- Individual Events
- Presentations
- Virtual Events

Accreditations: Western Illinois University is accredited by the Higher Learning Commission and is a member of the North Central Association. In addition, many of its departments and schools are accredited by professional agencies, including the following: Academy of Nutrition and Dietetics; Accrediting Council for Collegiate Graphic Communications, Inc.; American Speech-Language-Hearing Association; The Association of Technology, Management, and Applied Engineering; The Association to Advance Collegiate Schools of Business-International; Commission on Accreditation of Athletic Training Education; Commission on Collegiate Nursing Education; Commission on English Language Program Accreditation; Council for Accreditation of Counseling and Related Educational Programs; Council on Social Work Education; Engineering Accreditation Commission of ABET; Iowa College Student Aid Commission; Masters of Psychology and Counseling Accreditation Council; National Association of Schools of Art and Design; National Association of Schools of Music; National Association of Schools of Theatre; National Council for Accreditation of Teacher Education (NCATE); National Council for State Authorization Reciprocity Agreements; and National Recreation and Park Association. Western Illinois University is approved by the Illinois Board of Higher Education to participate in the National Council for State Authorization Reciprocity Agreements (NC-SARA). As such, the University's distance learning program follows policies and standards that are overseen by the National Council for State Authorization Reciprocity Agreements and administered by four regional higher education compacts. For additional information, please visit <http://nc-sara.org>.

Western Illinois University does not discriminate on the basis of race, color, national origin, sex, sexual orientation, gender identity, gender expression, marital status, disability, age, religion, genetic information, or veteran status, in its programs and activities, including employment and admission. Contact Stephanie Kinkaid, Title IX Coordinator and Director of Office of Equal Opportunity and Access at titleix@wiu.edu

Printed by authority of the State of Illinois • 8/2020 • 5,000 • 21001A

Undergraduate Admissions

admissions@wiu.edu

(309) 298-3157

1 University Circle, Macomb IL 61455

[@wiuadmissions](https://www.wiu.edu/admissions) | [@westerniluniv](https://www.westerniluniv.edu)



**Western Illinois
University**